

# HyperSWASH

## Single / Twingo / Combo

LINEAR DIRECT SPRAY AGAINST SURFACE TECHNOLOGY (Single, Twingo)  
or  
LINEAR TANGENTIAL SPRAY TECHNOLOGY (Combo)



### Single configuration

(upon request)

Usable space between the nozzles is 215 mm  
(107 mm from axis to one and to second side)

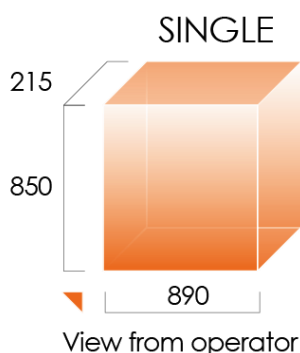

### Twingo configuration

Usable space between the nozzles is 60 mm  
(30 mm from axis to one and to second side)

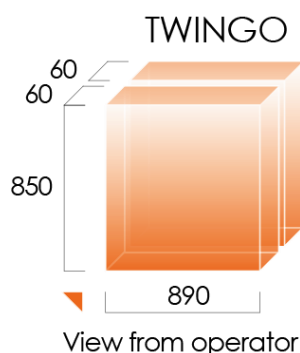

### Combo configuration

Usable space between the nozzles is 170 mm (160 mm from the basket bottom)

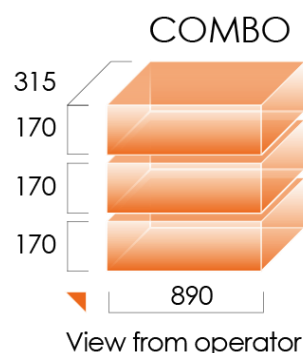

- Particular position and space depends on given clamping
- Specific requirements to be consulted with manufacturers' representatives
- Customization available upon request

## Cleaning technology

**Spray in air washing (max = 60 °C), 1<sup>st</sup> rinse DI water (max. 40 °C), 2<sup>nd</sup> rinse DI water (max. 40 °C), hot air drying (max = 110 °C).**

Nozzle Arm with Air Blade  
SINGLE

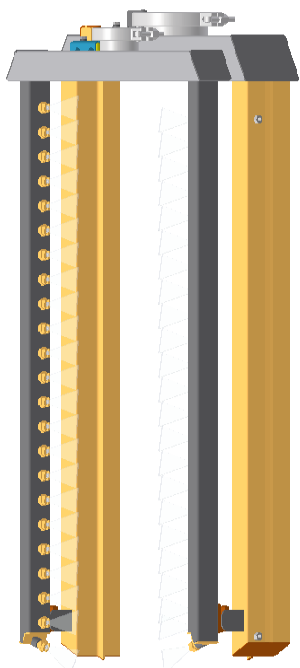

TWINGO

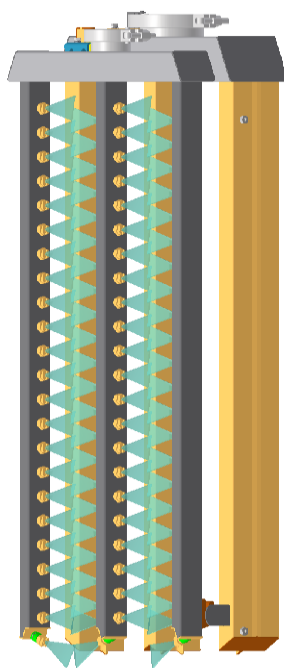

COMBO

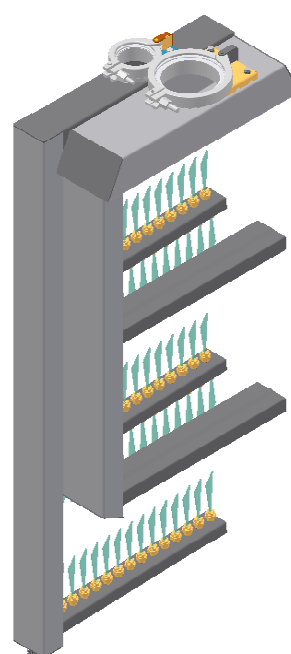

Mobile technological arms with spraying nozzles and air jets (air knife)

## Technical parameter

Machine dimension (WxLxH)	1 900 x 1 500 x 2 100 mm
Weight (without liquid)	1 000 kg
Machine noisiness	L <sub>Aeq</sub> <70 dB
Power supply voltage	3x 230 V/ 400 V, 50 Hz
Power input	25-30 kVA

## Adjustable parameters

All the parameters are adjusted by means of the LCD touch screen.

Washing time	0-99 min.
Washing medium temperature	Up to 60°C
Rinsing time	0-99 min.
Rinsing water temperature	Up to 40°C
Conductivity (II, IIR, IIR+,III)	0-999 µS/cm
Drying time	0-99 min.
Drying temperature	Up to 110°C
Number of program registers (settings)	99

*Note: All the adjusted parameters are not changed when the power supply is switched on or off.*

## Technological parameters

Working range (left - right limit)	0-105 (0-1 050 mm)
Washing – Max. pressure on the nozzles	3,1 Bar
Washing – Max. flow	155 Ltr/min
Rinsing – Max. pressure on the nozzles	2,2 Bar
Rinsing – Max. flow	135 Ltr/min
Tank volume – Max/Min	72/36 Ltr

*Note: The approximate values of pressure and flow are mentioned. The real values can be slightly different depending on the tolerances of used components. These differences have no effect for cleaning process.*

### Integrated Filtration Option Scheme

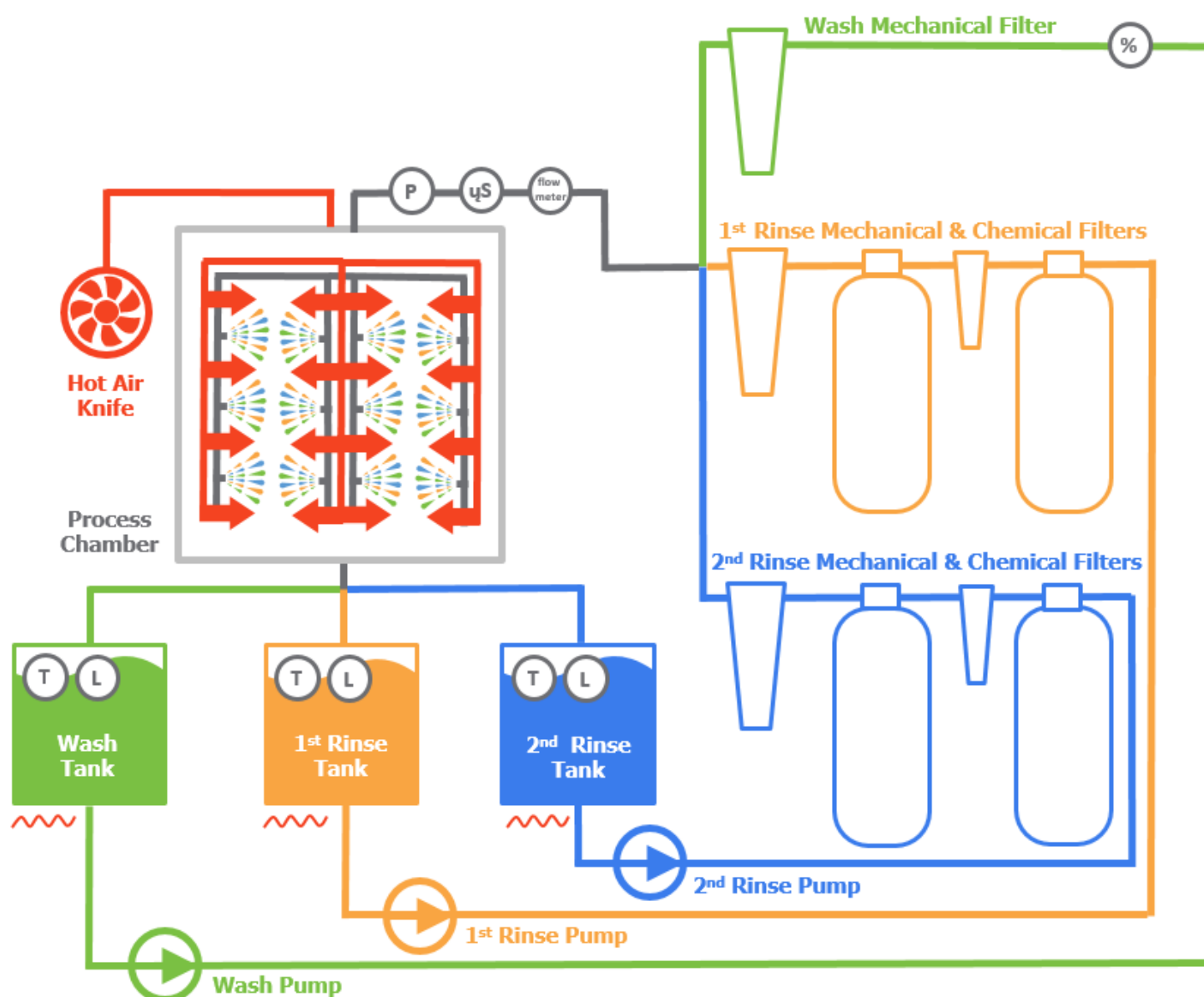

## Dimensions

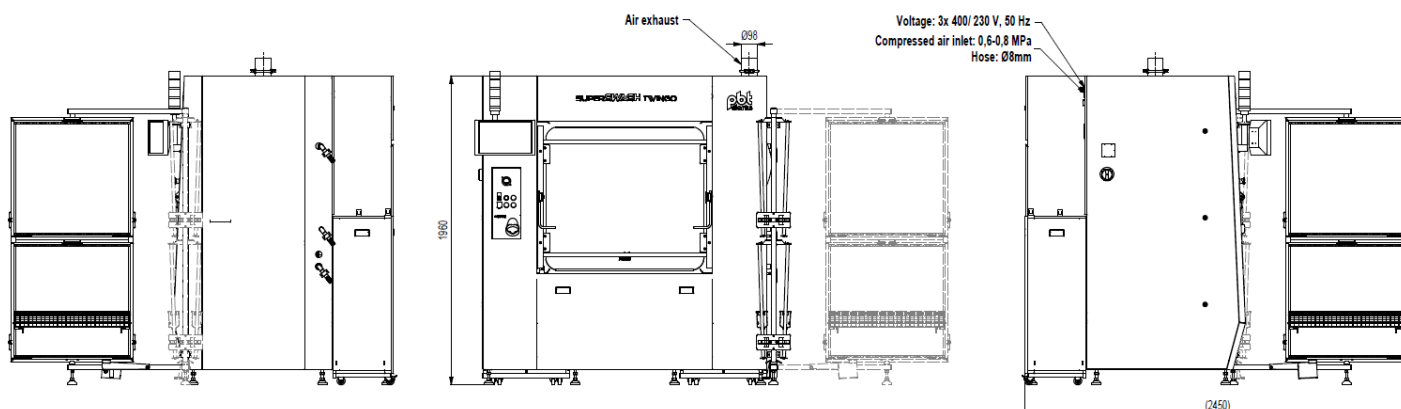

## Required service and maintenance area

From the front side minimal 1 000 mm  
tanks with working liquids)

Space for machine operation and maintenance (accessing to

From the right side minimal 700 mm  
From the right side minimal 1 200 mm

Access door for maintenance  
Revolving frame, access door

From the left side minimal 1 000 mm  
directive IEC 60364-1:2005), main switch

Accessing area into switchboard (in accordance with

From the rear part minimal 600 mm  
maintenance (filter pads replacement etc.)

Space for manipulation with filtration carts, machine

From above minimal 700 mm  
The height of the machine = **2 m**

space for door opening - ceiling height 2 600 mm

Top view:

